

A  
**WORLD**  
WITHIN



**CAPITAL**  
**MALL**

100+  
SHOPS

""Vwáhmbm AmdS>Umar, hdrhrer d mQ>Umar  
àÉ`oH\$ Jmoï> { \_job OdiM..."

### No aspiration is too far...

Be it your daily needs or your high-end luxury aspirations, nothing is too far from you at Capital City. With a grand Capital Mall and 500+ shops within the premises, the essential shopping and your favourite specific brands are close by. Simply walk to the best of the town collection and pick your selection with utmost joy.





### Legends

- |                                     |                                        |
|-------------------------------------|----------------------------------------|
| <b>A</b> Capital Square             | <b>G</b> Capital Industrial Complex I  |
| <b>B</b> Capital City               | <b>H</b> Capital Industrial Complex II |
| <b>C</b> Capital Industrial Park I  | <b>I</b> Nighoje Business Center       |
| <b>D</b> Nighoje Logistics          | <b>J</b> Capital Plaza                 |
| <b>E</b> Capital Industrial Park II | <b>K</b> Capital Mall                  |
| <b>F</b> Nighoje Logistics          | <b>L</b> Capital International School  |



## CAPITAL CITY

a world within

Residential | Commercial | Industrial

Make a move.

Be blessed by a rewarding future.

Belong to a place on earth that is destined to grow every moment. Spread across whopping 30 acre on the fastest developing growth corridor of Pune, this is a paradise of good fortune & golden opportunities! Here, the residential development comprising 1 & 2 BHK, studio apartments is surrounded by educational, commercial, industrial, entertainment & leisure hubs. An office, a shop, an industrial gala or unit, a grand showroom, a well-equipped healthcare facility or a home here where every treasured happiness is within easy reach is for the forward thinking people who see beyond future and make the most of the present. Welcome to the Growth Hub.

Near Talawade IT Park,  
Opp. Mahindra & Mahindra, Pune.



**MALL &  
MULTIPLEX**



**CAPITAL  
MALL**

Spread across 1 acre Plus  
5 storeyed commercial complex  
100+ Shops of 300 to 1500 sq. ft.  
Restaurant of 5000 sq. ft.  
Mall of 5000 to 25000 sq. ft.  
3 Screen Multiplex  
Gaming Zone  
ATM Kioks & Bank

**Key Features & Amenities**

Elevators | Escalator | Wi-fi connectivity  
Multilevel Parking | Fire Systems  
Generator Backup for common Area



Escalator



CAPITAL MALL

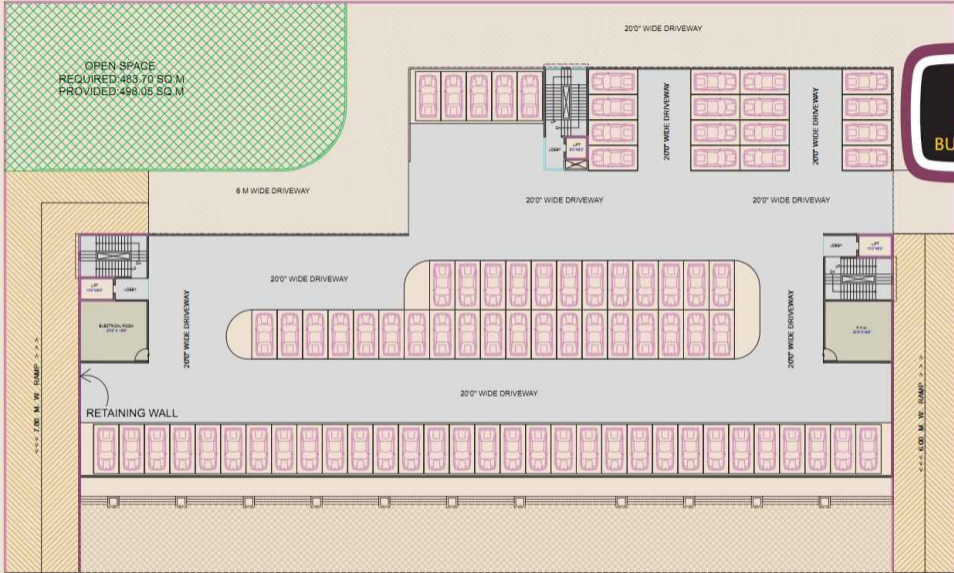

LOWER GROUND FLOOR PLAN



OPEN SPACE

**K**  
BUILDING

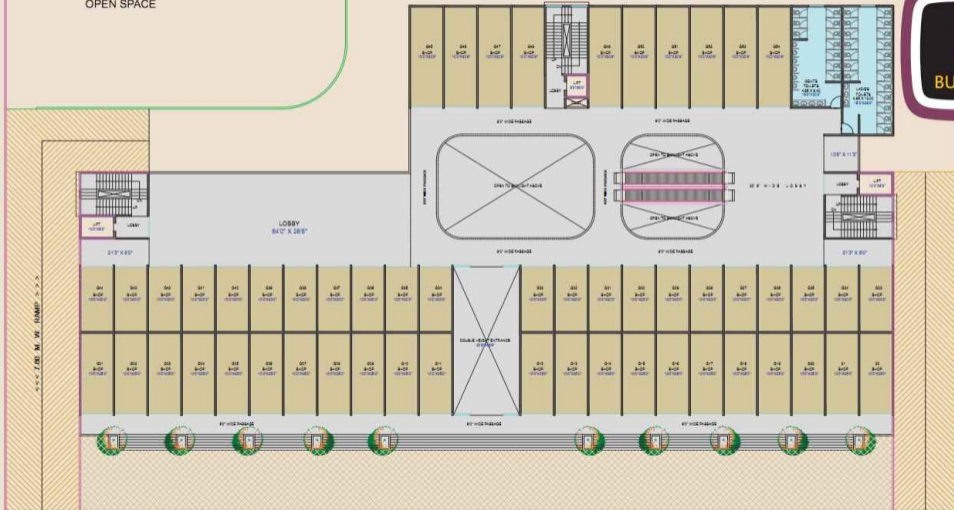

UPPER GROUND FLOOR PLAN ( SHOPS )





FIRST FLOOR PLAN ( SHOPS )

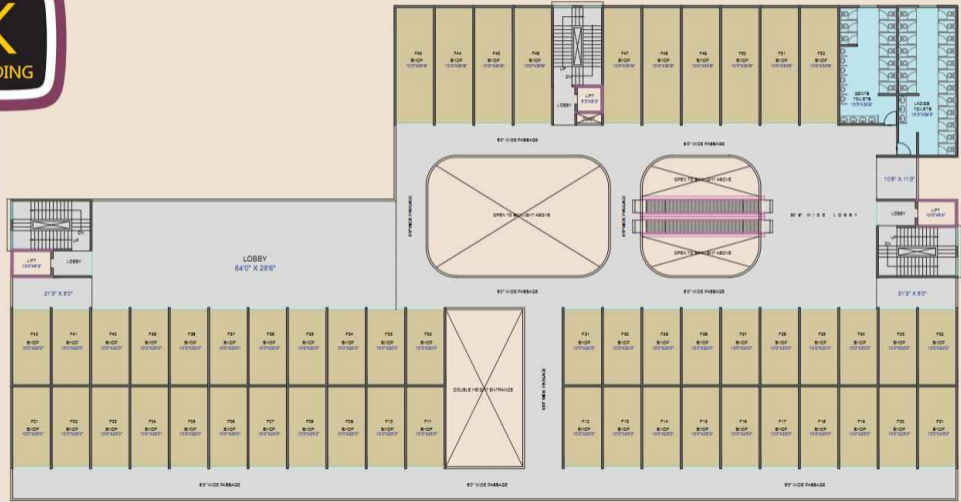
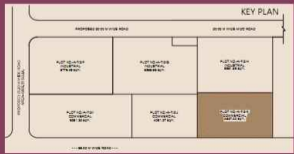







SCREEN 1 CAPACITY = 199  
 SCREEN 2 CAPACITY = 289  
 SCREEN 3 CAPACITY = 289



THIRD FLOOR PLAN ( MULTIPLEX )

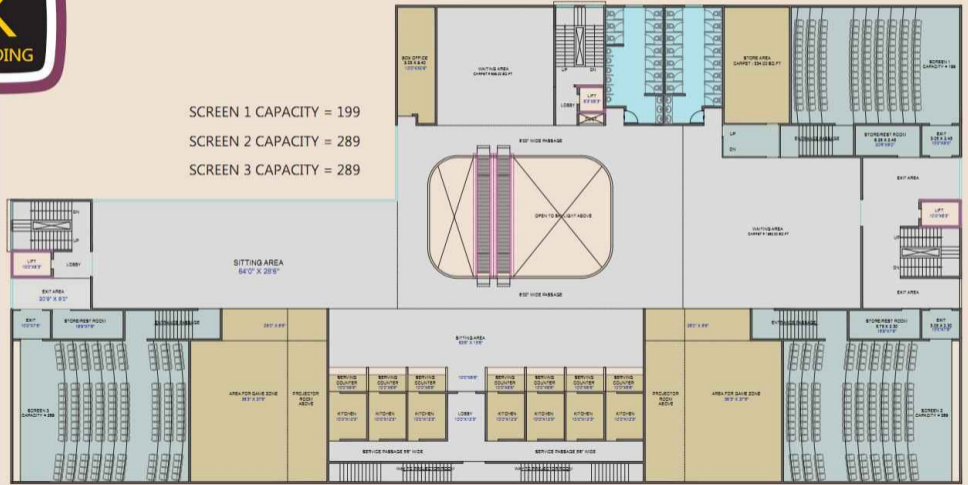
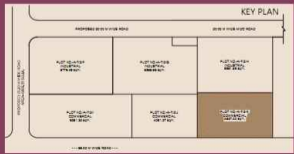





## The Rising Location

PCMC has long been the preferred territory of the new-age, progressive families. But this location where Capital City is being constructed, is a refreshingly pleasant surprise. It is bang opposite to Mahindra & Mahindra Plant of Nighoje, simply a few seconds from Chakan-Talegaon Road. The Chakan MIDC is on a 5 minutes drive and fast-developing Talawade IT Park is at hardly any distance of just 2 kilometers. It means, Capital City is strategically placed near manufacturing & IT hubs of PCMC. Besides easy connectivity to upmarket suburbs of Nigdi, Akurdi, Bhosari, Chinchwad etc. elevate the standards of living here. So be it professional, career opportunities or an empowered lifestyle, the new rising location of PCMC upholds a wonderful living experience for sure.

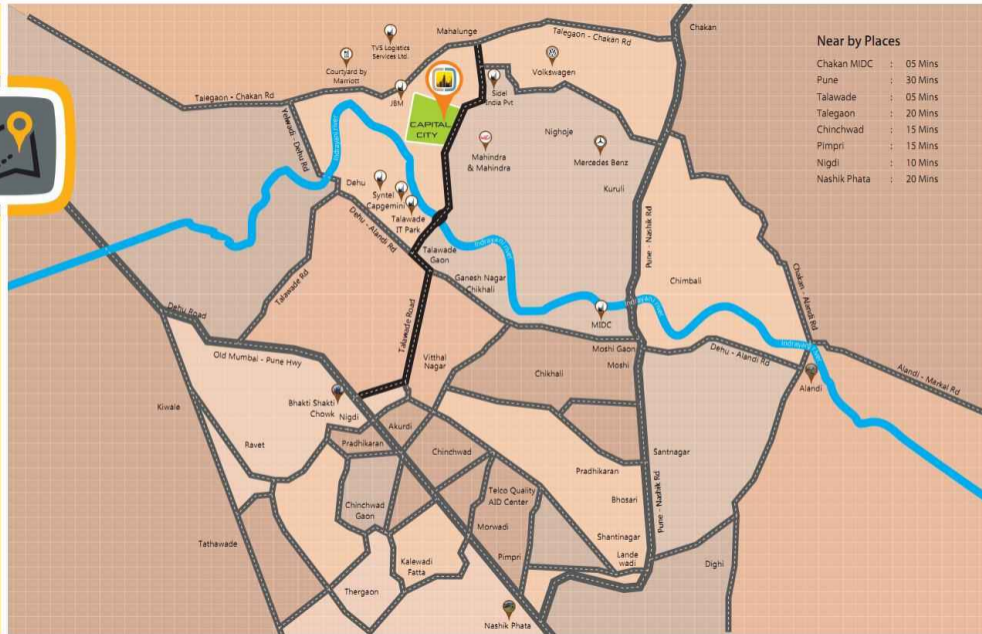



Office : CTS 4441, Hotel Kundan Place, Mumbai - Pune Road, Akurdi, Pune - 35 | Ph.: 020 2724 2424

Site Address : Near Talawade IT Park, Opp. Mahindra & Mahindra, Nighoje, Pune

Ph.: 70660 40544 | 70300 03344 | Email : [sales@capitalcity.co.in](mailto:sales@capitalcity.co.in) | website : [www.capitalcity.co.in](http://www.capitalcity.co.in)